

PORT WILLIAM

LIBERTY TWP., CLINTON CO., OHIO
 JAMES R. NIMZ, CO. ENG'R

1984

SCALE: 1" = 200'

DEC 31 1984

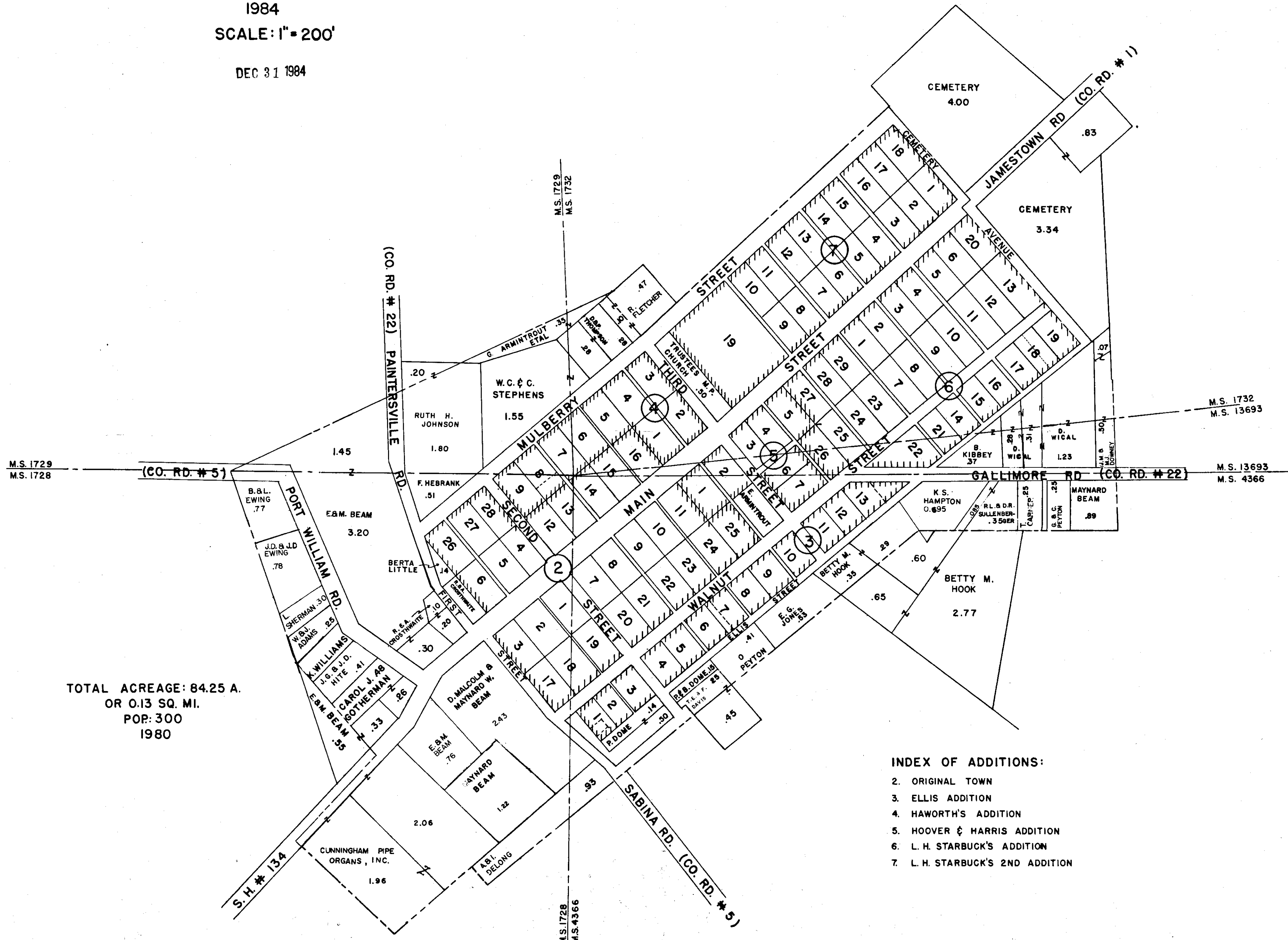

TOTAL ACREAGE: 84.25 A.
 OR 0.13 SQ. MI.
 POP: 300
 1980

- INDEX OF ADDITIONS:**
- 2. ORIGINAL TOWN
 - 3. ELLIS ADDITION
 - 4. HAWORTH'S ADDITION
 - 5. HOOVER & HARRIS ADDITION
 - 6. L. H. STARBUCK'S ADDITION
 - 7. L. H. STARBUCK'S 2ND ADDITION