

# PORT WILLIAM

LIBERTY TWP., CLINTON CO., OHIO  
 JAMES R. NIMZ, CO. ENG'R

1983  
 SCALE: 1" = 200'

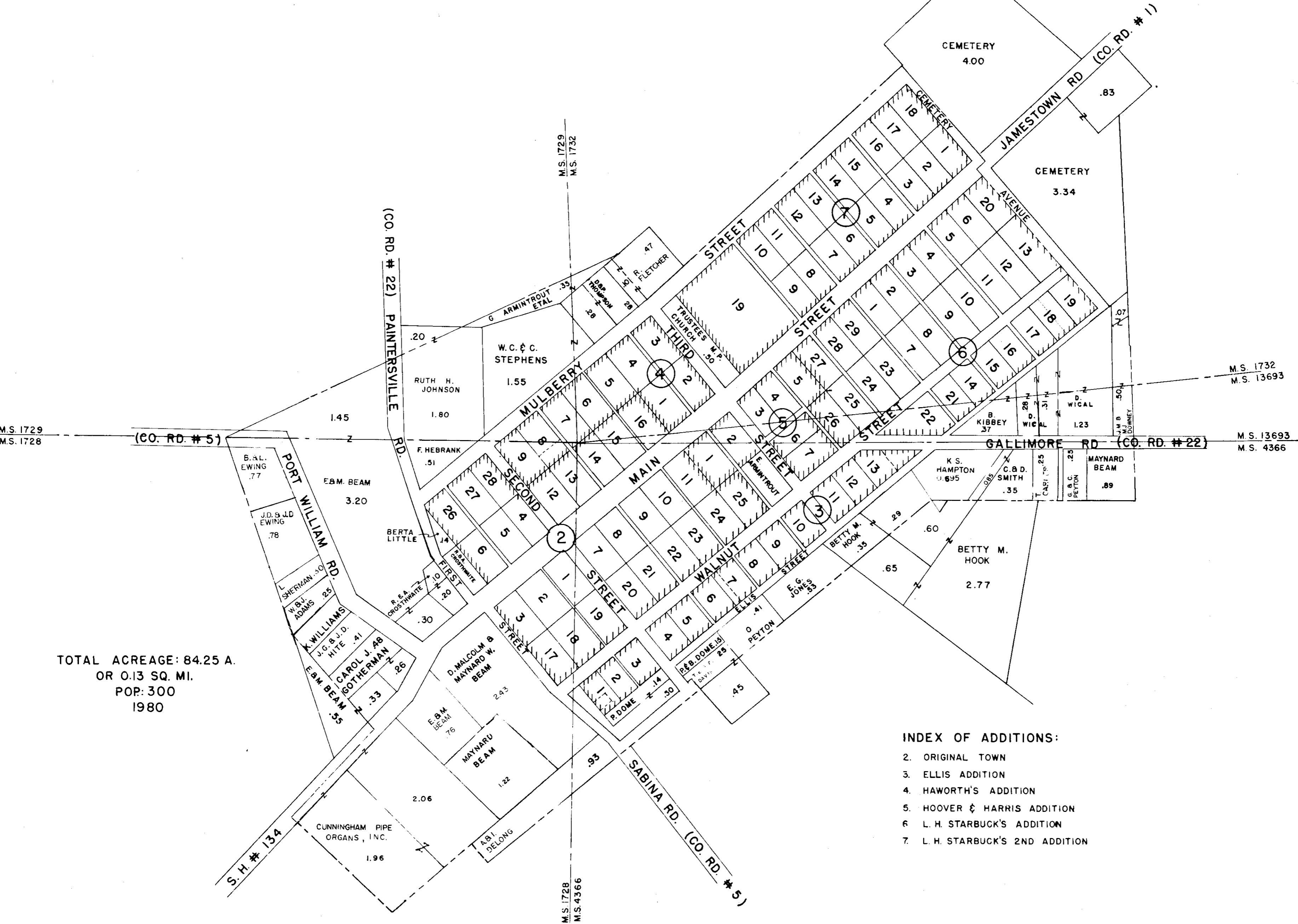

TOTAL ACREAGE: 84.25 A.  
 OR 0.13 SQ. MI.  
 POP: 300  
 1980

- INDEX OF ADDITIONS:
2. ORIGINAL TOWN
  3. ELLIS ADDITION
  4. HAWORTH'S ADDITION
  5. HOOVER & HARRIS ADDITION
  6. L. H. STARBUCK'S ADDITION
  7. L. H. STARBUCK'S 2ND ADDITION