

# PORT WILLIAM

LIBERTY TWP., CLINTON CO., OHIO  
 JAMES R. NIMZ, CO. ENG'R  
 1980

SCALE: 1" = 200'

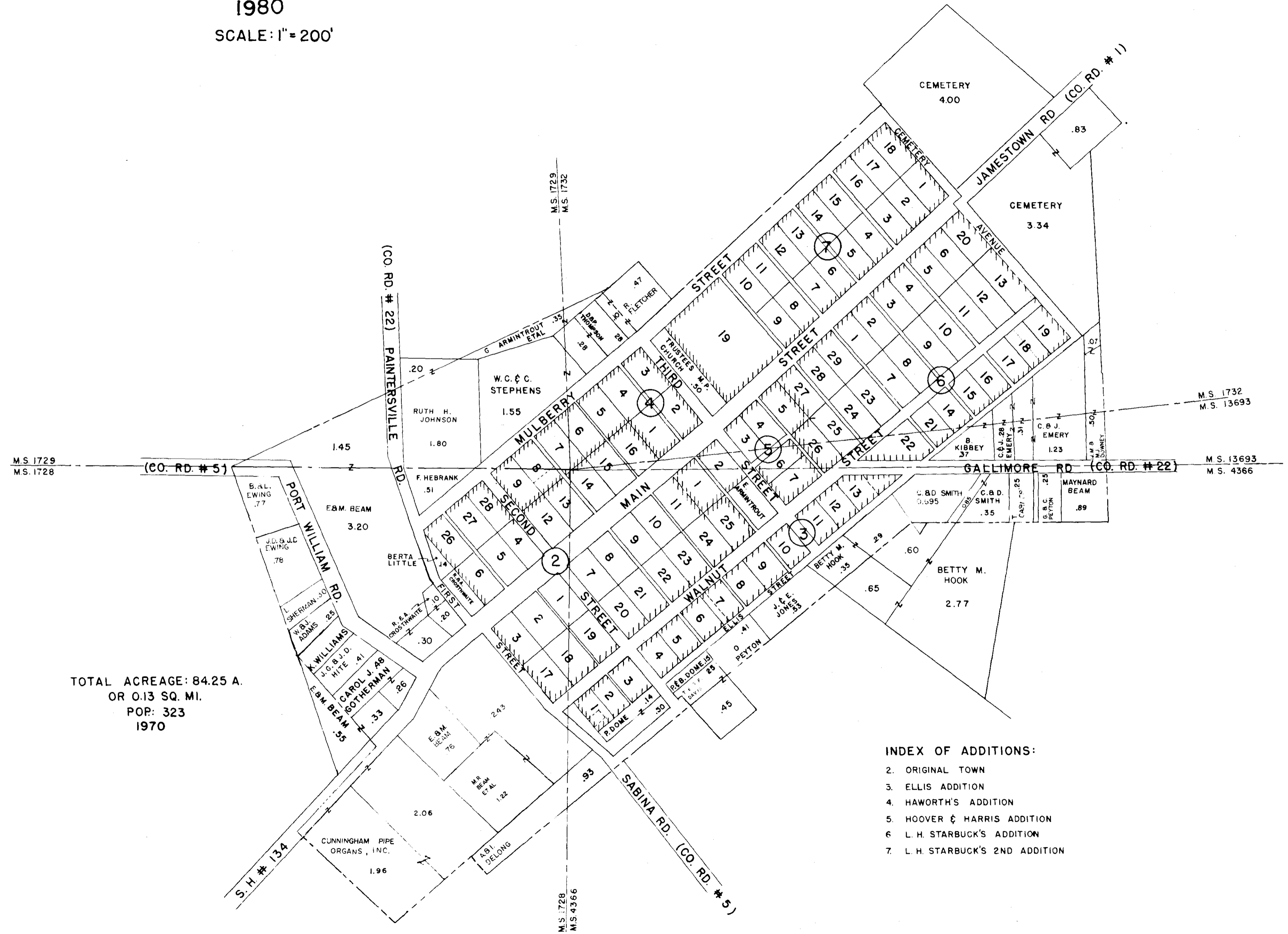

TOTAL ACREAGE: 84.25 A.  
 OR 0.13 SQ. MI.  
 POP: 323  
 1970

**INDEX OF ADDITIONS:**

2. ORIGINAL TOWN
3. ELLIS ADDITION
4. HAWORTH'S ADDITION
5. HOOVER & HARRIS ADDITION
6. L. H. STARBUCK'S ADDITION
7. L. H. STARBUCK'S 2ND ADDITION

DEC 3 1 1980

EXCLUSIVE RIGHTS RESERVED  
 BY  
 CLINTON COUNTY ENGINEER