

NORTH KINGMAN

CHESTER TOWNSHIP
CLINTON COUNTY, OHIO
MIL. SUR. 2231
WILLIAM T. TEMPLE, CO. ENG'R
SCALE: 1" = 200'

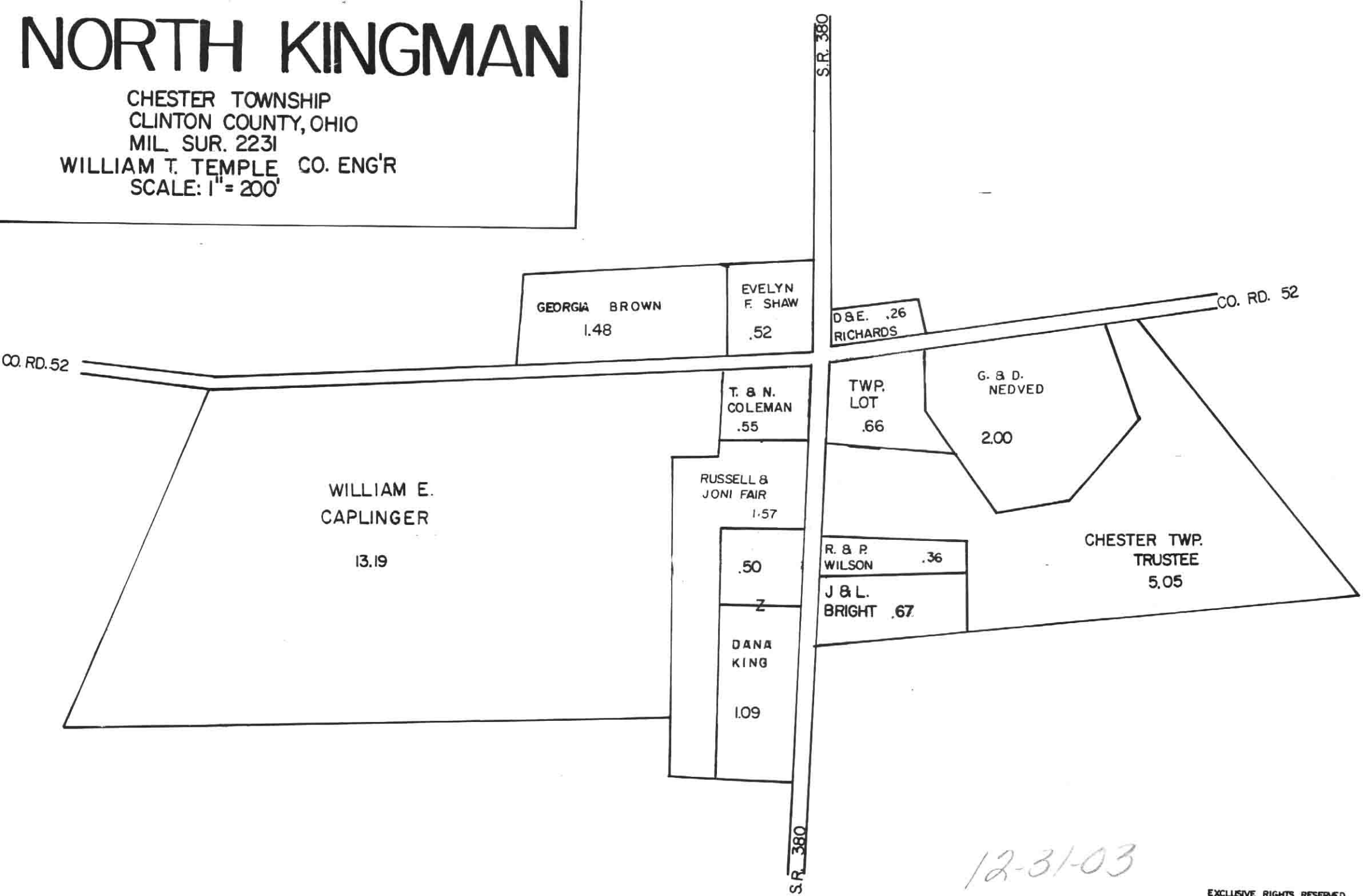

GEORGIA BROWN
1.48

EVELYN
F. SHAW
.52

D & E. .26
RICHARDS

CO. RD. 52

CO. RD. 52

WILLIAM E.
CAPLINGER
13.19

T. & N.
COLEMAN
.55

TWP.
LOT
.66

G. & D.
NEDVED
2.00

RUSSELL &
JONI FAIR
1.57

.50

R. & P.
WILSON .36

CHESTER TWP.
TRUSTEE
5.05

J & L.
BRIGHT .67

DANA
KING

1.09

S.R. 380

12-31-03