

# NORTH KINGMAN

CHESTER TOWNSHIP  
CLINTON COUNTY, OHIO  
MIL. SUR. 2231  
WILLIAM T. TEMPLE, CO. ENG'R  
SCALE: 1" = 200'

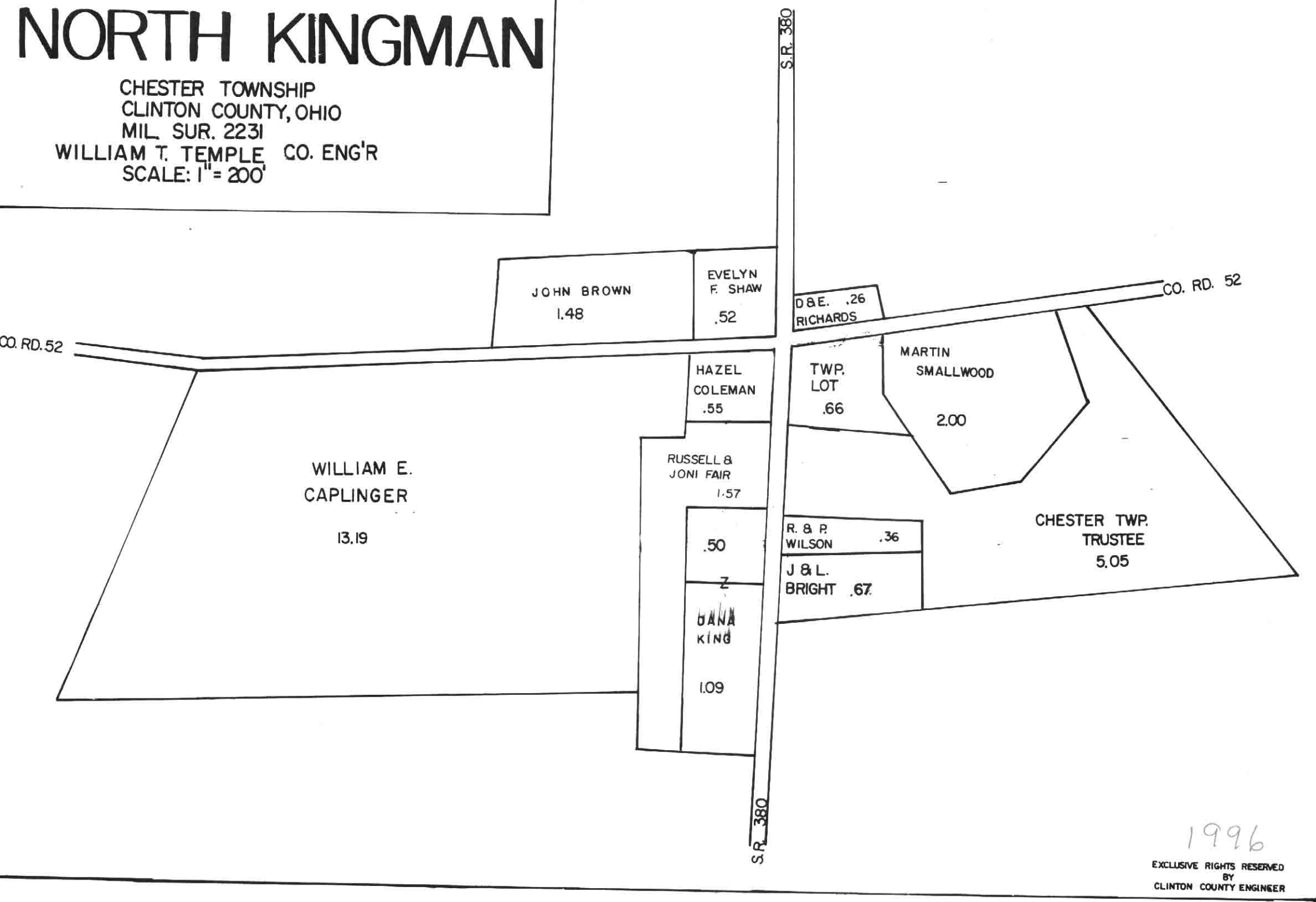

JOHN BROWN  
1.48

EVELYN  
F. SHAW  
.52

D & E. .26  
RICHARDS

CO. RD. 52

CO. RD. 52

HAZEL  
COLEMAN  
.55

TWP.  
LOT  
.66

MARTIN  
SMALLWOOD  
2.00

WILLIAM E.  
CAPLINGER  
13.19

RUSSELL &  
JONI FAIR  
1.57

R. & P.  
WILSON  
.36

CHESTER TWP.  
TRUSTEE  
5.05

.50

J & L.  
BRIGHT .67

Z  
DANA  
KING

1.09

S.R. 380

S.R. 380

1996

EXCLUSIVE RIGHTS RESERVED  
BY  
CLINTON COUNTY ENGINEER