

INDEX OF SUBDIVISIONS & ADDITIONS

- 2. ORIGINAL TOWN
- 3. CAREY'S ADDITION
- 4. COLLEGE HEIGHTS
- 5. JOHNSON & DALTON ADDITION
- 6. K. OF P. ADDITION
- 6A. ROLLIN' ACRES SUBDIVISION

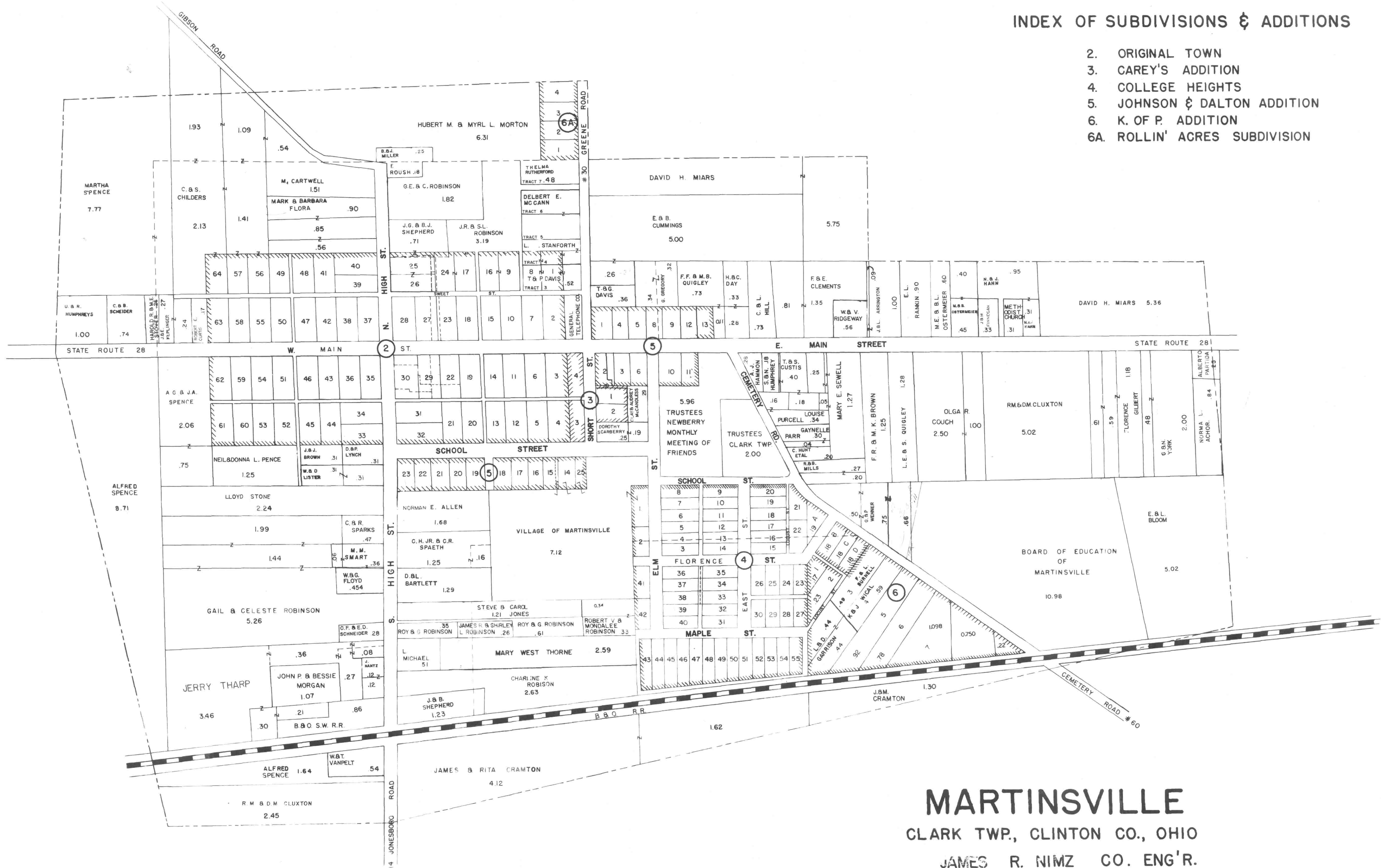

MARTINSVILLE
 CLARK TWP., CLINTON CO., OHIO
 JAMES R. NIMZ CO. ENG'R.
 SCALE: 1" = 200'

1984
 DEC 31 1984

TOTAL ACREAGE: 256.44 A.
 OR 0.40 SQ. MI.
 POP: 500
 1970