

CARTER, GEORGE
 STURGEON, JEREMIAH
 STURGEON, ROBERT
 MILLS, DAVID I.

WAR	ROW	GRAVE
①	1	11
①	1	17
①	3	34 W
①	4	32

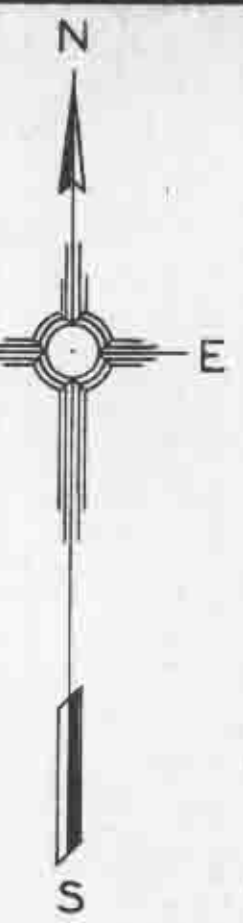

THORPE CEMETERY
 CLINTON CO. WILSON TWP.
 OFFICIAL PROJECT NO. 465-42-3-467 & 665-42-3-232
LEGEND **HISTORY**
 ① CIVIL WAR EST. PRIOR TO 1853
 ② WAR WITH SPAIN SURVEY 830 P. DRAFFEN
 DONOR EDMUND THORPE
 SCALE 20' = 1" .30 ACRE

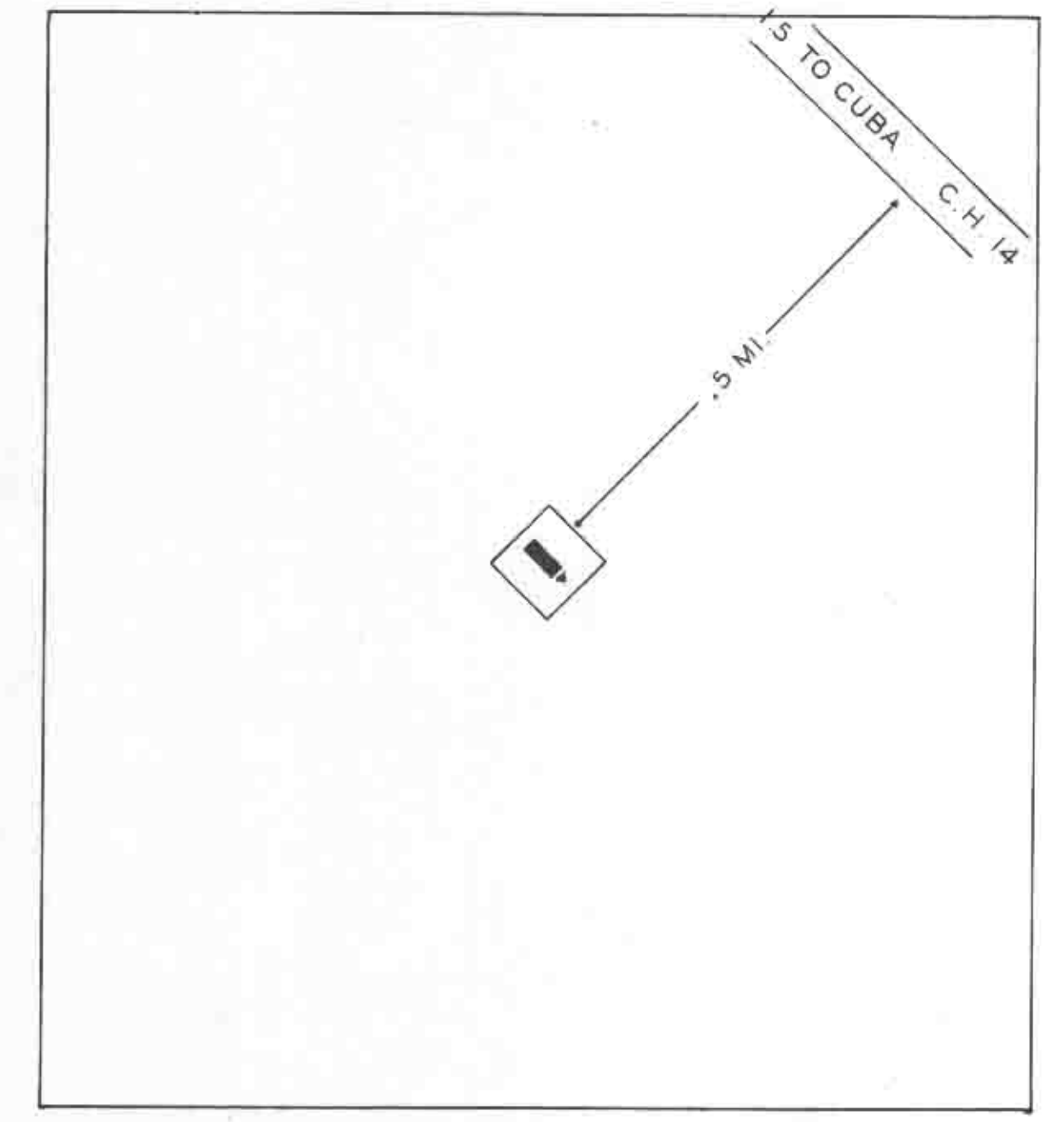

MANN, JACOB

WAR	LOT	GRAVE
⑩	1	1

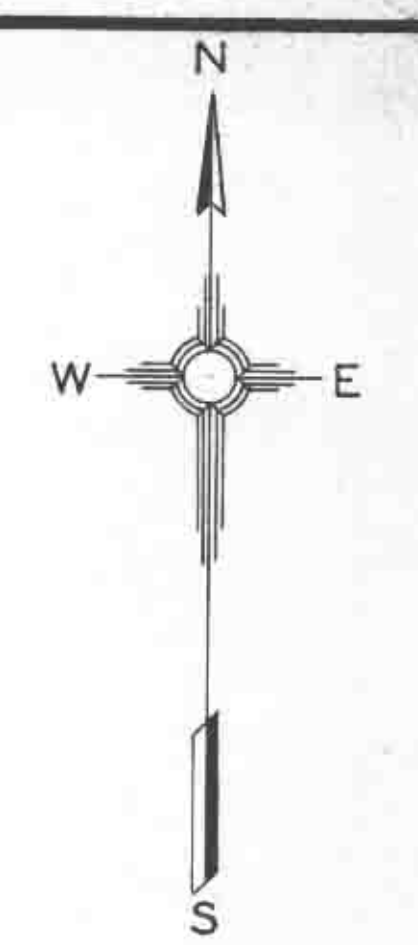

MANN CEMETERY
 CLINTON CO. WASHINGTON TWP.
 OFFICIAL PROJECT NO. 465-42-3-467 & 665-42-3-232
LEGEND **HISTORY**
 ⑩ WAR OF 1812 SURVEY 1457 J. BLACKWELL
 SCALE 20' = 1" .05 ACRE

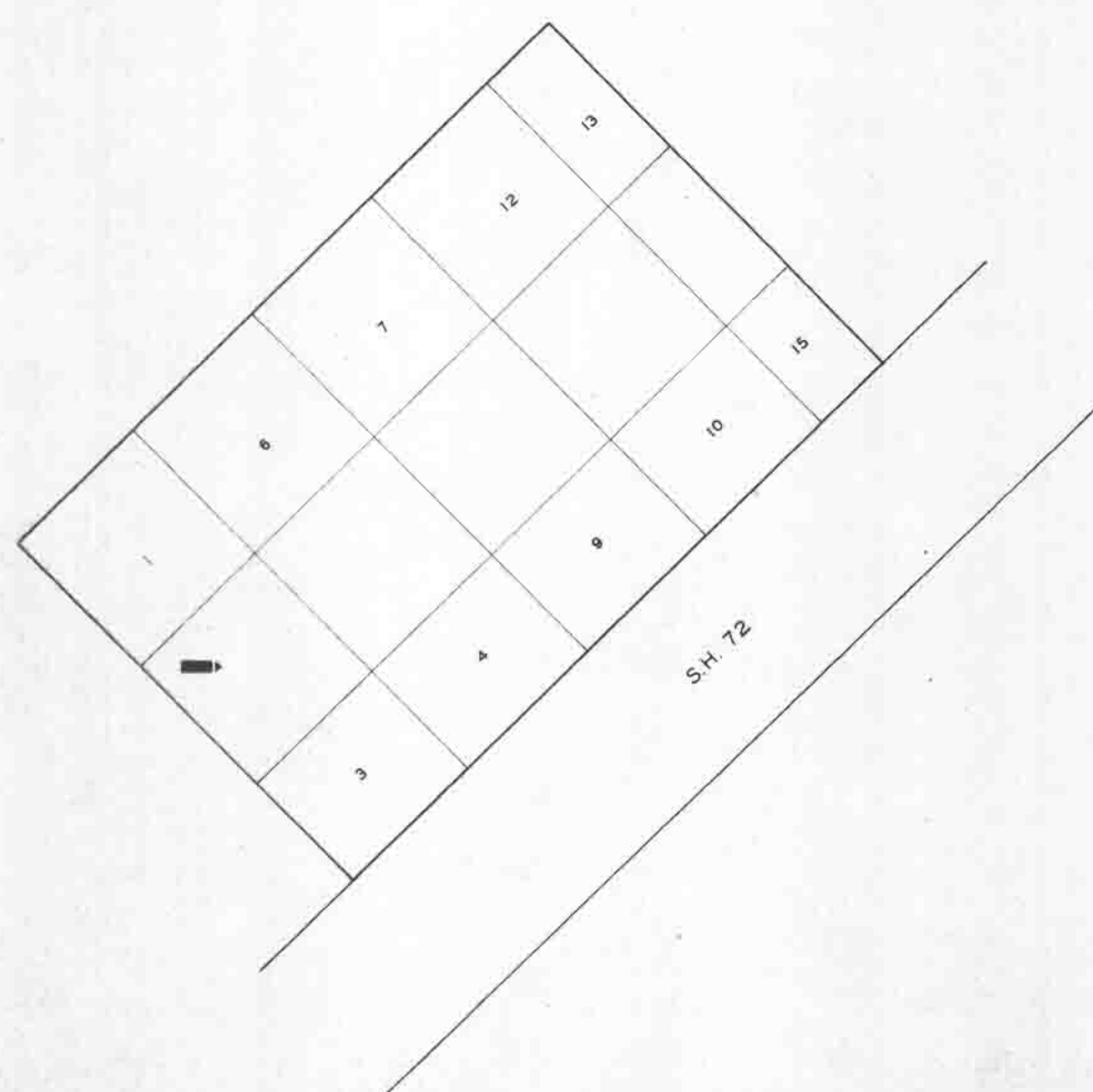

NANCE, HARRY W.

WAR	LOT	GRAVE
③	2	7

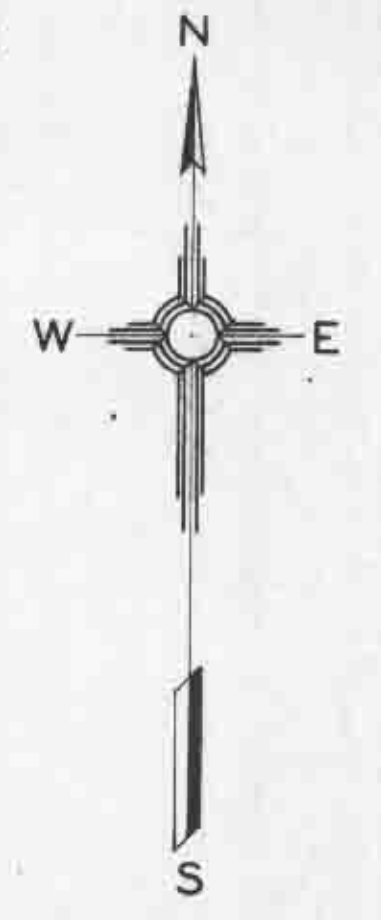

RICHLAND NEGRO CEMETERY
 CLINTON CO. WAYNE TWP.
 OFFICIAL PROJECT NO. 465-42-3-467 & 665-42-3-232
LEGEND **HISTORY**
 ① CIVIL WAR SURVEY 1023 W. WHITACRE
 ③ WORLD WAR
 SCALE 20' = 1" .21 ACRE

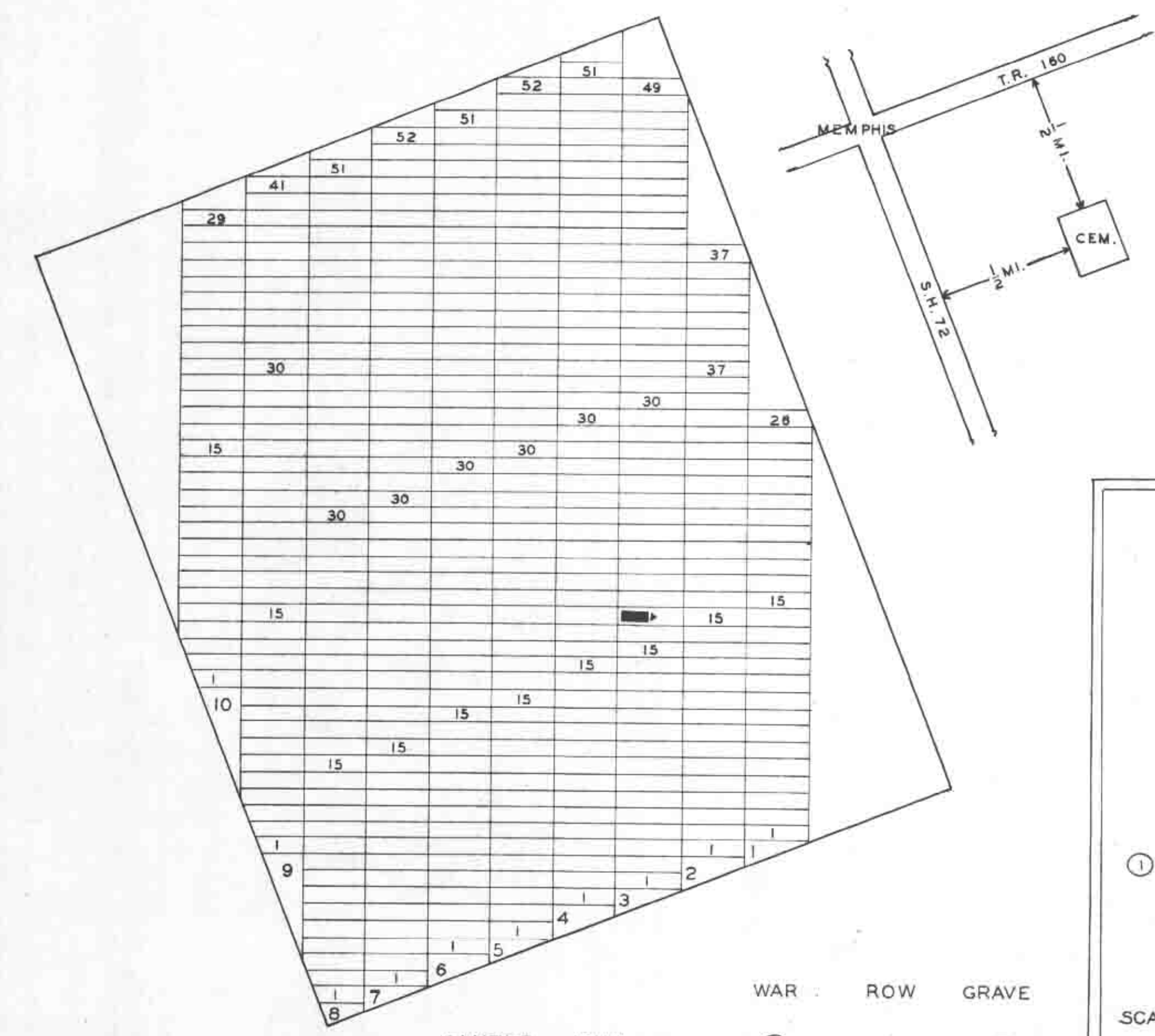

CANTER, JOHN

WAR	ROW	GRAVE
①	3	17

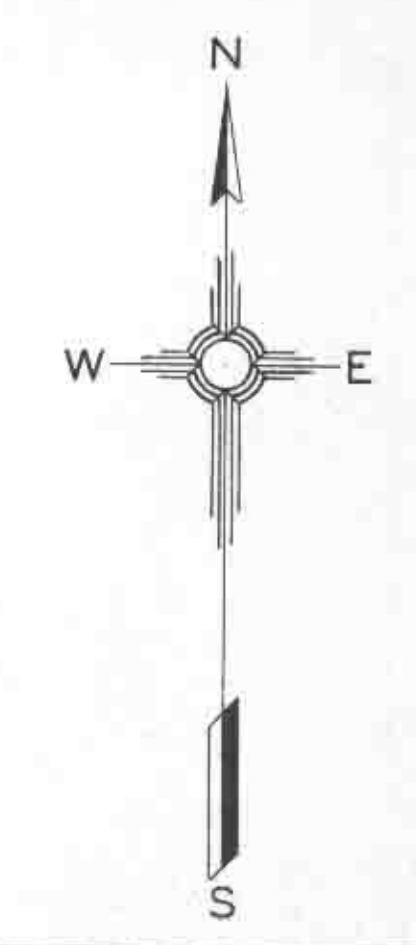

LUTTREL CEMETERY
 CLINTON CO. WAYNE TWP.
 OFFICIAL PROJECT NO. 465-42-3-467 & 665-42-3-232
LEGEND **HISTORY**
 ① REVOLUTION, EST. 1844
 PREVIOUSLY CALLED
 GROVES CEMETERY
 SURVEY 1027 T. RANSDALE
 SCALE 20' = 1" .42 ACRE