

	WAR	ROW	GRAVE
ANSON, CLINTON	⑩	4	23
MILLER, JOHN	⑩	13	51

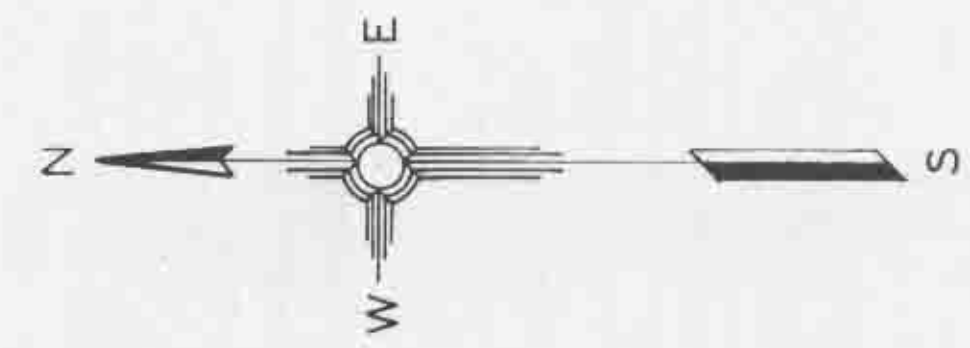
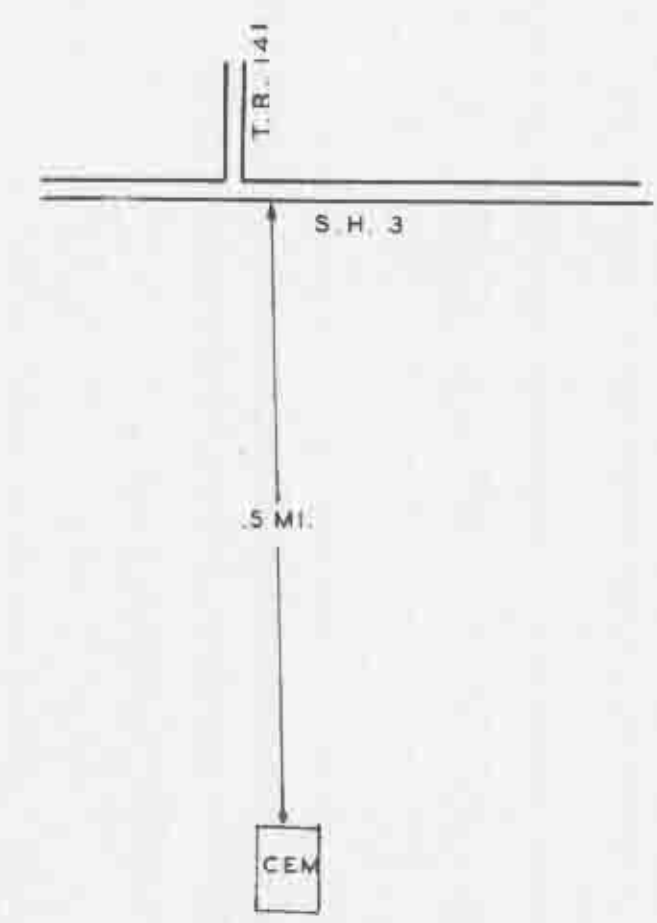

LYTLE CREEK CEMETERY
CLINTON CO. UNION TWP.

OFFICIAL PROJECT NO 465-42-3-467 & 665-42-3-232

LEGEND	HISTORY
① REVOLUTION	EST. 1817
⑩ WAR OF 1812	SURVEY 1554 H. GATES
⑪ CIVIL WAR	

SCALE 20' = 1" .130 ACRE

← CLARKSVILLE .5 MI. S.H. 3

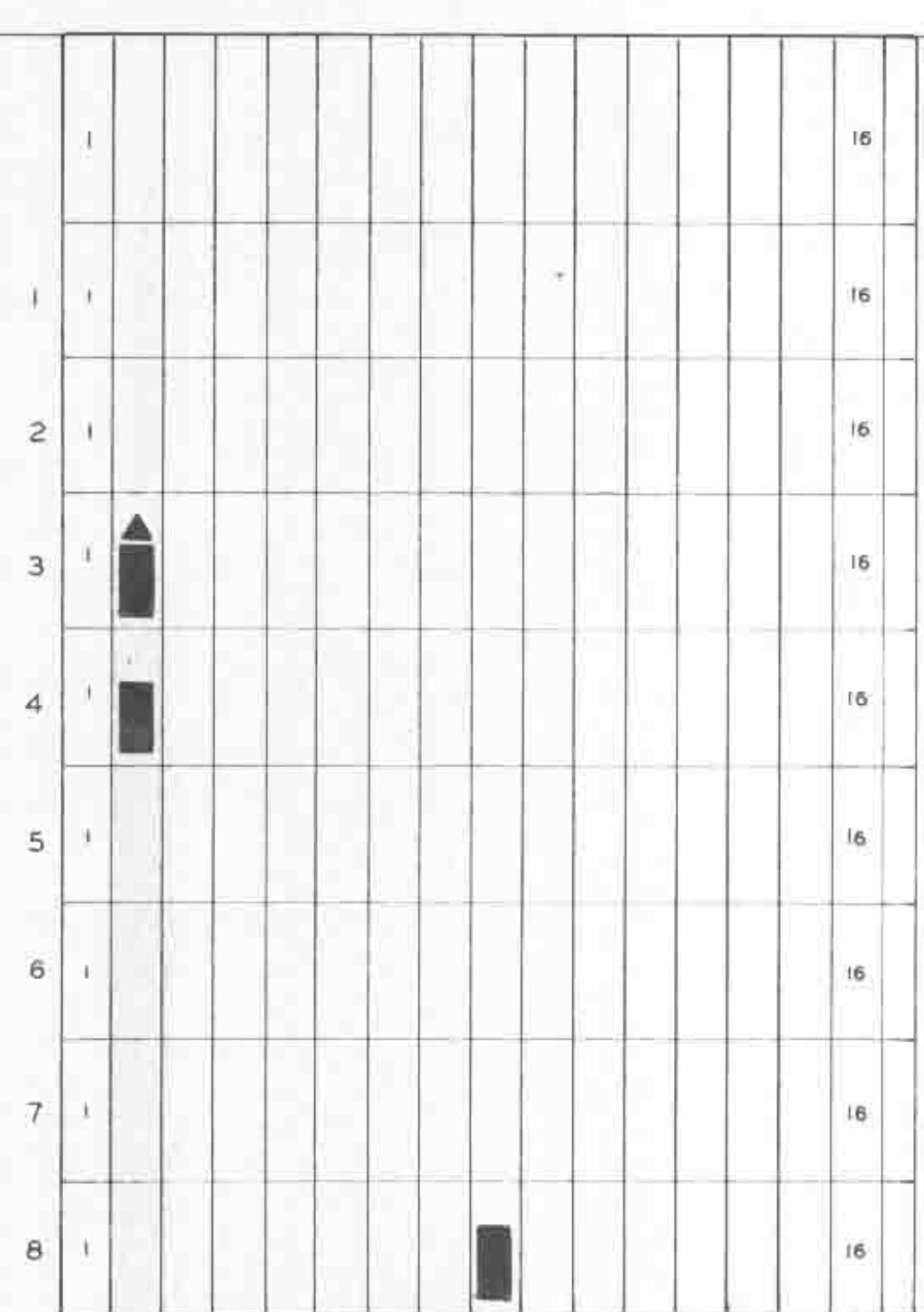

	WAR	LOT	GRAVE
HUDGEL, JOHN	⑩	7	9
WILKERSON, GEORGE	⑩	3	2
WILKERSON, WILLIAM	⑩	4	2

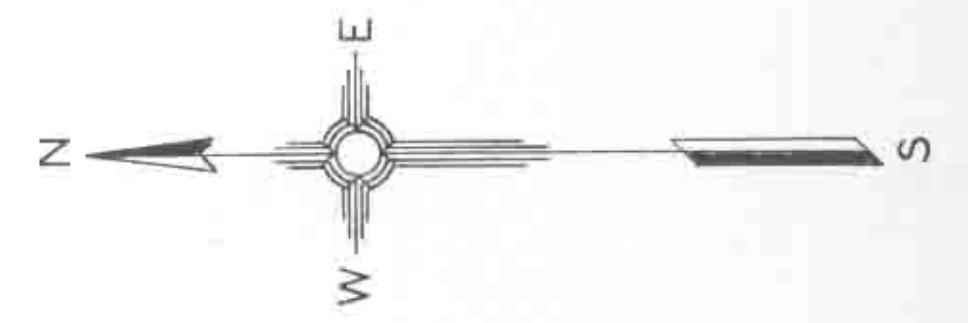

QUAKER (CLARKSVILLE) CEMETERY
CLINTON CO. VERNON TWP.

OFFICIAL PROJECT NO. 465-42-3-467 & 665-42-3-232

LEGEND	HISTORY
⑩ WAR OF 1812	EST. PRIOR TO 1840
⑪ MEXICAN WAR	SURVEY 2227 W. BOYCE
⑫ CIVIL WAR	DONOR WM. HADLEY

SCALE 10' = 1" .10 ACRE

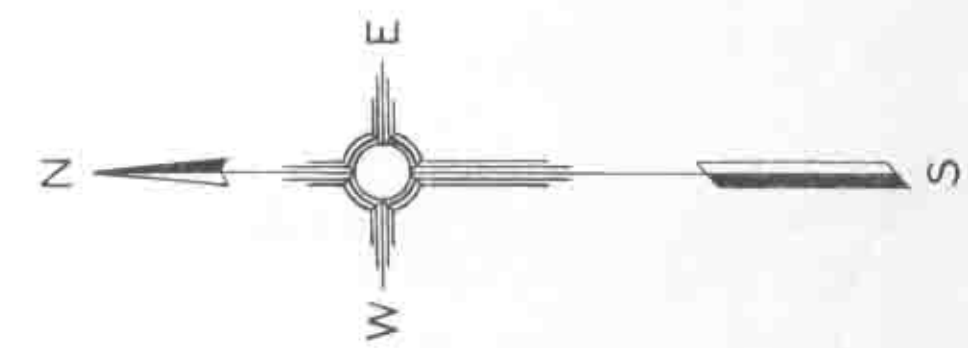
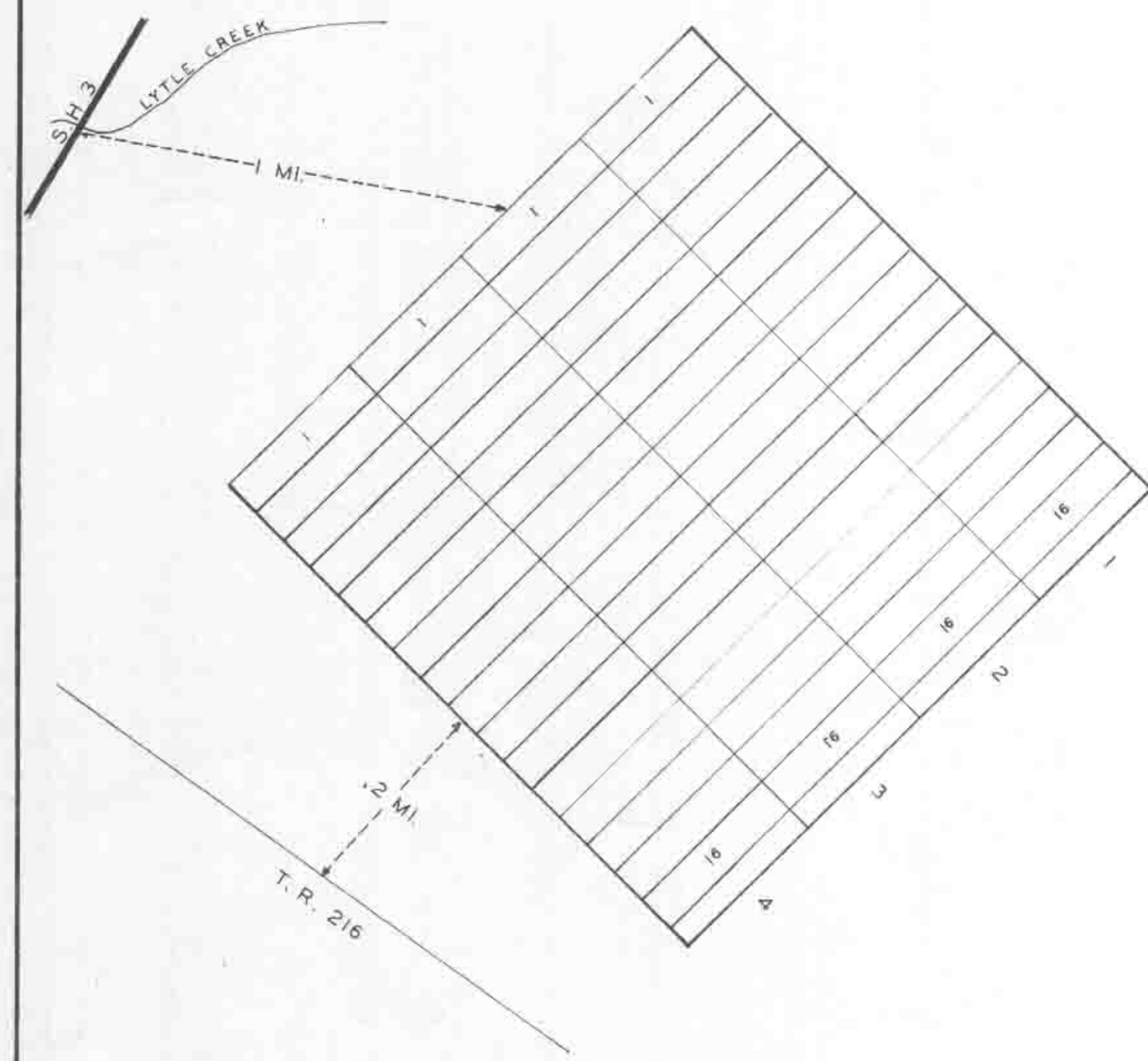

JENKS CEMETERY
CLINTON CO. ADAMS TWP.

OFFICIAL PROJECT NO 465-42-3-467 & 665-42-3-232

LEGEND	HISTORY
⑩ WAR OF 1812	EST. PRIOR TO 1830
⑫ CIVIL WAR	SURVEY 2189 A. DUDLEY

SCALE 10' = 1" .10 ACRES