

1" = 40'

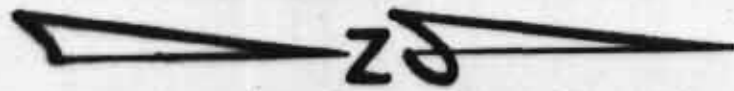

**LEGEND**

- DENOTES ENLARGING ADDITION TO CEMETERY (SEE VOL. PLAT OF THE CLINTON COUNTY ENGINEER'S RECORD OF LAND DIVISION.)
- DENOTES OVERHEAD ELECTRICAL LINES
- - - - - DENOTES NUMBER / CABLE LOCATION
- ⊕ DENOTES UTILITY POLE LOCATION

**NOTES**

- ALL REGULAR PATHWAYS ARE 6 FT. IN WIDTH
- THE ENLARGING ADDITION IS COMPRISED OF 480 10'x10' PLOTS

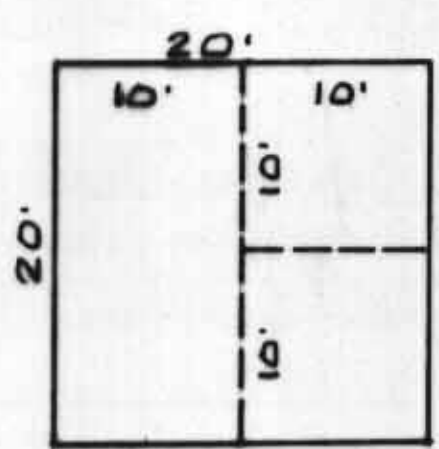
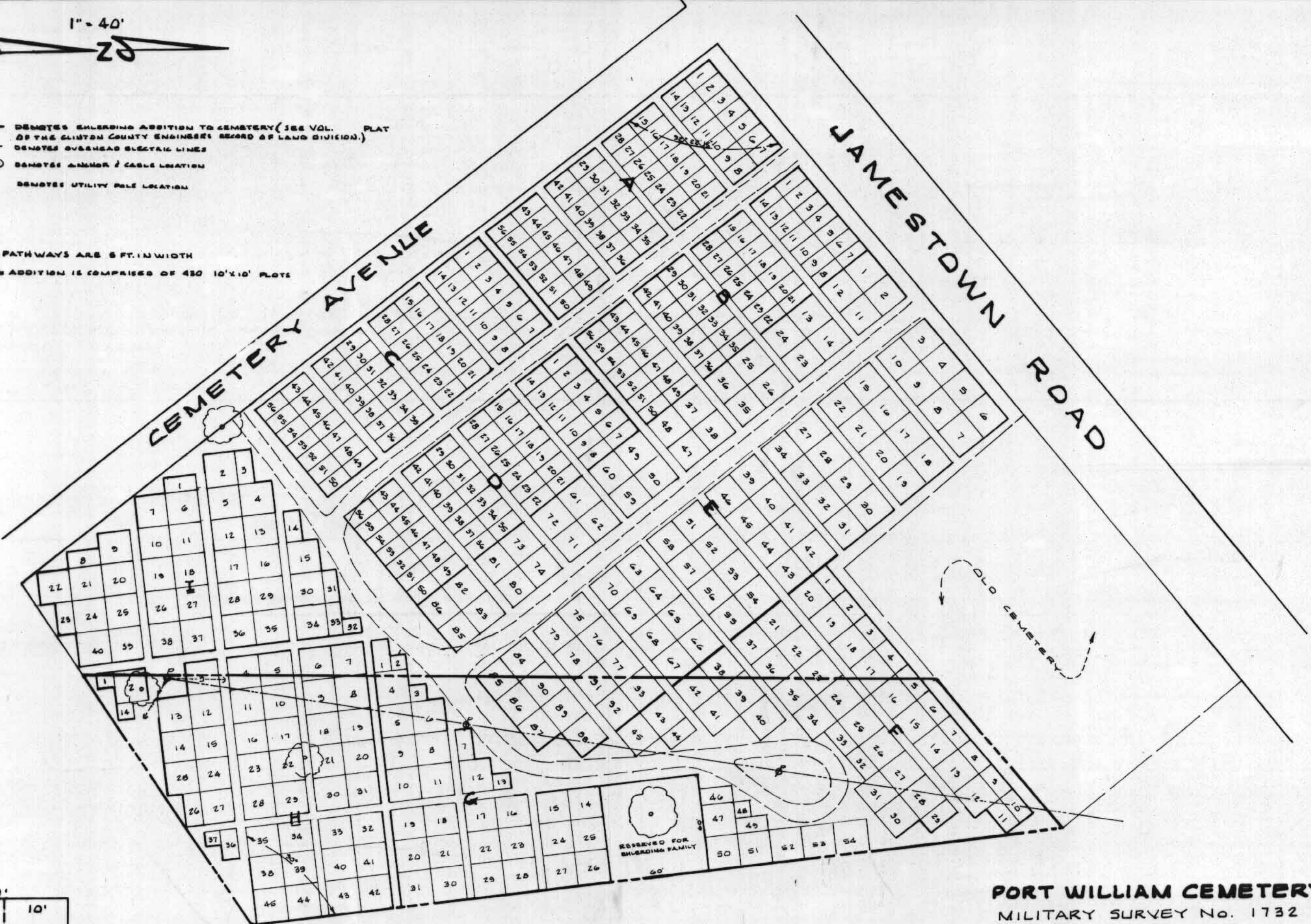

TYPICAL PLOT SIZES  
1" = 10'

*Brian F. Gallagher*  
BRIAN F. GALLAGHER P.S. No. 6946



**PORT WILLIAM CEMETERY**  
MILITARY SURVEY No. 1732  
LIBERTY TOWNSHIP  
CLINTON COUNTY, OHIO

**SOUTHWEST OHIO  
LAND SURVEYS**  
P.O. BOX 201 WILMINGTON, OHIO

SCALE 1" = 40'	DRAWN BY BFG	DATE MARCH 20, 89
1824415		